

Model	Filter Area m ²	Filter Qty	A	B	C	D	E PCD	F	G	H No of Valves	Approx Weight Kg
SFJC4-1-06	4.0	4	450	530	650	16	495	320	475	2	55
SFJC4-1.6-10	6.4	4	450	530	1050	16	495	320	475	2	71
SFJC6-1-06	6.0	6	600	680	650	20	645	327	482	3	75
SFJC6-1.6-10	9.6	6	600	680	1050	20	645	327	482	3	97
SFJC9-1-06	9.0	9	700	780	650	20	745	395	550	3	91
SFJC9-1.6-10	14.4	9	700	780	1050	20	745	395	550	3	118
SFJC12-1-06	12.0	12	800	880	650	24	845	470	625	3	111
SFJC12-1.6-10	19.2	12	800	880	1050	24	845	470	625	3	144
SFJC16-1-06	16.0	16	900	980	650	24	945	475	630	4	132
SFJC16-1.6-10	25.6	16	900	980	1050	24	945	475	630	4	177
SFJC20-1.6-10	32.0	20	1000	1080	1050	24	1045	475	630	5	192
SFJC24-1.6-10	38.4	24	1100	1180	1050	32	1145	475	630	6	217
SFJC28-1.6-10	44.8	28	1250	1330	1050	32	1295	475	630	7	257
SFJC30-1.6-10	48.0	30	1200	1280	1050	32	1245	584	753	6	282

TECHNICAL SPECIFICATION

ELECTRICAL SUPPLY:

Cleaning controller input- 24v DC / 110/230v 1ph 50hz (by client)
Solenoid valve - 24v DC

CONSTRUCTION:

- Mild Steel
- Ra17032, Light Grey
- See Quotation

Vacuum & Pressure Rating - See Quotation

COMPRESSED AIR:

- 6 bar max.
- 5.1 m³/hr (for SFJC4 to SFJC9)
- 6.7 m³/hr (for SFJC12 to SFJC28)
- 10.8 m³/hr (for SFJC30)
- (Based on 15 sec interval & 100msec. pulse)

FILTER MEDIA:

Various Media Systems Available To Suit Dust Characteristics.
(See Quotation).

OPTIONS:

- ATEX Certified
- Differential Pressure Monitor
- Stainless Steel
- Special Paint Finish
- Filter Regulator

DSR (dirty side removal) - Filter removal from below



**DUST COLLECTORS
DUST CONTROL SYSTEMS
CARTRIDGE FILTER ELEMENTS
MAINTENANCE & COSHH SURVEYS**

Web : www.dustcheck.co.uk
Email : sales@dustcheck.co.uk
Phone : 01782 599454

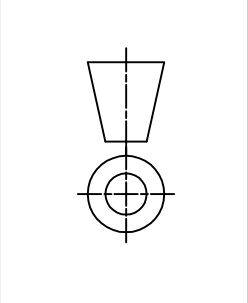
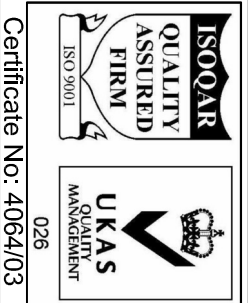

This drawing is private and confidential and is the property of Dustcheck LTD. It must not be copied or loaded or used for manufacturing or tendering purposes without the written consent of Dustcheck LTD.

Title: **VENTMATIC 120 SERIES**
CIRCULAR VENTING FILTER (DSR) WITH UPSTAND

Drawn: **R.G.** Date: **10/3/16** Drawing No: **D76** Rev: **L**